



1JA

1. Insert tubing into jacketing. leave 1.5" extra.¹ Remove retaining ring.
2. Thread tubing through backshell bushing. Press jacketing over backshell bushing.²
3. Install tubes onto fittings.
4. Snap backshell onto retaining ring groove.
5. Tighten collar until backshell is firmly attached. (0-1 thread showing)



2

3

4

5

2JA, 2.5JA & 3JA

1. Insert tubing into jacketing. Have at least 1.5" extra from the end.¹ Remove retaining ring.
2. Thread tubing through backshell bushing. Snap threaded ring onto retaining ring groove.
3. Install tubes onto fittings.
4. Screw backshell onto threaded ring. Use screwdriver on notch above slit to hold ring.
5. Push jacketing over bushing.²

1. Additional tubing length will aid in flexibility and prevent tube pull out. Larger tube bundles will require more than smaller bundles. Each application will have different requirements. Always begin with more and shorten as necessary.
2. Rigid vacuum hose may not require securing. Flexible hose may require a hose clamp. Spiral or braided wrap can be secured with wire ties.



Manufactured by:
Twintec, Inc.
1510 Boundary Blvd.,
Suite 100
Auburn, WA 98001
253-218-0890 ph.
253-218-0892 fx.
800-979-9645 Toll free
www.twintecinc.com
info@twintecinc.com

Distributed by:

Flotronics
AUTOMATION

4260 Giddings Rd.
Auburn Hills, MI 48326

P. 248-625-8890
sales@flotronicsautomation.com
www.flotronicsautomation.com

TWINTEC
Inc

MULTIPLE TUBE
CONNECTORS

Time.

Fast operation for quick change-overs.

Simple.

All tubes are contained in one bundle and connected in one operation.

Enhance.

Regular maintenance and repair; tooling and equipment sections can be swapped out quickly and worked on away from the production environment



Rugged.

Solid aluminum construction suitable for many industrial applications while maintaining cabinet integrity.

Build.

Controls and tooling can be manufactured separately at the best supplier then brought together.

Versatile.

Wide variety of options and capabilities to fit your particular needs.

Quick and easy selection chart

1. Choose tube OD or Port Thread 2. Select # of tubes 3. Choose component Accessories

	Tube OD	# Tubes	Assembly	Plug (Male)	Socket (Female)	Plug cover	Socket cover	★
BC - PUSH-IN STYLE FITTINGS	1/8"	4	1.2BC-4-12	1.2BC-4P-12	1.2BC-4S-12	1.2-DCP	1.2-DCS	1.2JA
		10	2BC-10	2BC-10P	2BC-10S	2-DCP	2-DCS	2JA
		12	2BC-12	2BC-12P	2BC-12S	2-DCP	2-DCS	2JA
		19	2.5BC-19	2.5BC-19P	2.5BC-19S	2.5-DCP	2.5-DCS	2.5JA
	5/32" (4mm)	4	1.2BC-4-16	1.2BC-4P-16	1.2BC-4S-16	1.2-DCP	1.2-DCS	1.2JA
		10	2BC-10-16	2BC-10P-16	2BC-10S-16	2-DCP	2-DCS	2JA
		12	2BC-12-16	2BC-12P-16	2BC-12S-16	2-DCP	2-DCS	2JA
		24	3BC-24-16	3BC-24P-16	3BC-24S-16	3-DCP	3-DCS	2.5JA
	1/4"	6	2BC-6	2BC-6P	2BC-6S	2DCP	2-DCS	2JA
		8	2BC-8	2BC-8P	2BC-8S	2DCP	2-DCS	2JA
		12	2.5BC-12	2.5BC-12P	2.5BC-12S	2.5-DCP	2.5-DCS	2.5JA
		19	3BC-19	3BC-19P	3BC-19S	3-DCP	3-DCS	3JA
BH - THREADED PORTS	3/8"	6	2.5BC-6	2.5BC-6P	2.5BC-6S	2.5-DCP	2.5-DCS	2.5JA
		12	3BC-12	3BC-12P	3BC-12S	3-DCP	3-DCS	3JA
	10-32	4	1BH-7	1BH-7P	1BH-7S	1-DCP	1-DCS	1JA .40
		7	1BH-7	1BH-7P	1BH-7S	1-DCP	1-DCS	1JA .30
		8	2BH-8	2BH-8P	2BH-8S	2-DCP	2-DCS	2JA .41
		12	2BH-12	2BH-12P	2BH-12S	2-DCP	2-DCS	2JA .40
	1/8" NPT	16	2BH-16	2BH-16P	2BH-16S	2-DCP	2-DCS	2JA .32
		19	2BH-19	2BH-19P	2BH-19S	2-DCP	2-DCS	2JA .30
		19	2.5BH-19	2.5BH-19P	2.5BH-19S	2.5-DCP	2.5-DCS	2.5JA .56
		22	2.5BH-22	2.5BH-22P	2.5BH-22S	2.5-DCP	2.5-DCS	2.5JA .30
	1/4" NPT	4	2BH-4-12	2BH-4P-12	2BH-4S-12	2-DCP	2-DCS	2JA .56
		6	2.5BH-6	2.5BH-6P	2.5BH-6S	2.5-DCP	2.5-DCS	2.5JA .72
		9	2.5BH-9	2.5BH-9P	2.5BH-9S	2.5-DCP	2.5-DCS	2.5JA .56
		12	3BH-12	3BH-12P	3BH-12S	3-DCP	3-DCS	3JA .67
BH - THREADED PORTS	3/8" NPT	12	3BH-12	3BH-12P	3BH-12S	3-DCP	3-DCS	3JA .67
		19	3BH-19	3BH-19P	3BH-19S	3-DCP	3-DCS	3JA .53
		5	2.5BH-5	2.5BH-5P	2.5BH-5S	2.5-DCP	2.5-DCS	2.5JA .79
		7	3BH-7-25	3BH-7P-25	3BH-7-25	3-DCP	3-DCS	3JA .79
	1/2" NPT	8	3BH-8	3BH-8P	3BH-8S	3-DCP	3-DCS	3JA .82
		7	3BH-7	3BH-7P	3BH-7S	3-DCP	3-DCS	3JA .79
		10	3BH-10	3BH-10P	3BH-10S	3-DCP	3-DCS	3JA .82
		15	3BH-15	3BH-15P	3BH-15S	3-DCP	3-DCS	3JA .82
	3/4" NPT	20	3BH-20	3BH-20P	3BH-20S	3-DCP	3-DCS	3JA .82
		25	3BH-25	3BH-25P	3BH-25S	3-DCP	3-DCS	3JA .82
		30	3BH-30	3BH-30P	3BH-30S	3-DCP	3-DCS	3JA .82
		40	3BH-40	3BH-40P	3BH-40S	3-DCP	3-DCS	3JA .82

Standard Specifications
 Maximum PSI: 125
 O-ring: Buna-N
 Gasket: EPDM
 Body: Aluminum
 Fittings: NP Brass, Brass
 Finish: Anodize

TWINTeC
Inc

PLUG

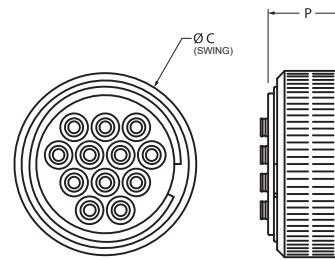

SOCKET

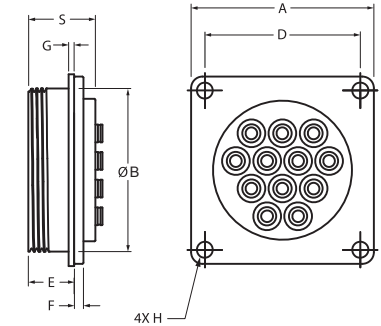

	SERIES	DIMENSION									
		A	B	C	D	E	F	G	H	P	S
	1BH	1.20	1.07	1.25	0.95	0.38	0.10	0.06	0.13	0.43	0.55
	1.2BC	1.38	1.19	1.39	1.12	0.58	0.13	0.06	0.13	0.63	0.71
	2BC	2.00	1.75	2.00	1.70	0.50	0.10	0.06	10-32	0.87	0.73
	2BH	2.00	1.75	2.00	1.70	0.50	0.10	0.06	10-32	0.87	0.60
	2.5	2.50	2.25	3.50	2.125	0.50	0.14	0.06	0.18	0.65	0.79
	3	3.35	3.00	4.00	2.50	0.75	0.25	0.06	0.25	0.75	1.00
	3" Series (3JA-□□)	3.35	3.00	4.00	2.50	0.75	0.25	0.06	0.25	0.75	1.00
	2.5" Series (2.5JA-□□)	2.50	2.25	3.50	2.125	0.50	0.14	0.06	0.18	0.65	0.79

★ Jacket adaptor (back shell) selection.

Our jacket adaptor accessory provides the means to protect and contain your tubing bundle along with the fitting interface of the connector. Select the adaptor one size up from the minimum size for best results.

Pick the available part number from the images below. The first number (series size) should match the first number on the connector component. The bushing ID is .10" smaller than the tube ID. The dash number represents the ID of the jacket hose you will use; 05 = .50", 07 = .75", 10 = 1.00", 12 = 1.25", 15 = 1.50", 17 = 1.75", 20 = 2.00" and 1NPT = 1.0" NPTF.

The jacket adaptor works with spiral wrap, braided wrap, tubing, and vacuum hose. See the back page for assembly instructions.

